



© the Plan Man 2005



Large Deck – Daylight Windows

## Luxury Townhomes

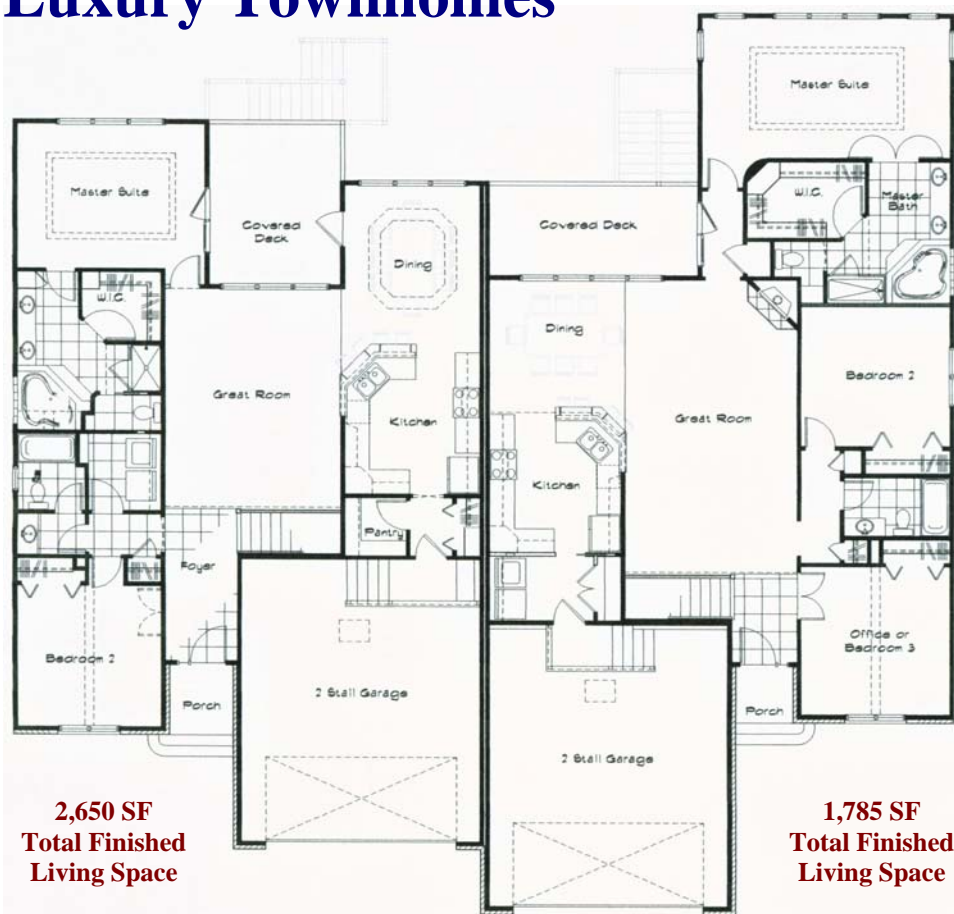

### Approximate Room Sizes:

Great Room	14'9" x 19'2"
Dining Room	11'5" x 14'3"
Kitchen	11'5" x 12'0"
Master Bedroom	15'9" x 12'4"
Bedroom #2	12'2" x 11'4"
Bedroom #3	15'0" x 13'8"

- Spacious great room plan with high ceilings and lots of windows
- Covered private decks
- Breakfast bar at kitchen
- Corian kitchen countertops
- Real hardwood floors in kitchen and dining areas
- Stainless steel appliances
- Convenient main level laundry with tile or wood floor
- Lighted coffered ceiling in Master Bedroom
- Luxurious Master Suite with full bath and walk-in closet
- Whirlpool tubs
- Ceramic tile baths
- Ceiling fans and lights in all bedrooms
- Fireplace option
- 7600 basement is finished
- Oversized 2 stall garage
- Sod and Sprinkler System

### Approximate Room Sizes:

Great Room	14'7" x 25'2"
Dining Room	11'1" x 9'5"
Kitchen	11'1" x 9'6"
Master Bedroom	21'0" x 12'0"
Bedroom #2	12'8" x 12'0"
Bedroom #3	12'8" x 12'8"



You are invited  
to visit our websites  
[KeystoneHomesofLincoln.com](http://KeystoneHomesofLincoln.com)  
or  
[LyonEnterprisesLLC.com](http://LyonEnterprisesLLC.com)